



**H-21**

SCALE: 1" = 5' VERT.  
50' HORIZ.

APPROVED BY THE MASON PLANNING BOARD

ON: 4 January 1990 CERTIFIED BY  
CHAIRMAN: J. David Thelander AND  
SECRETARY: \_\_\_\_\_

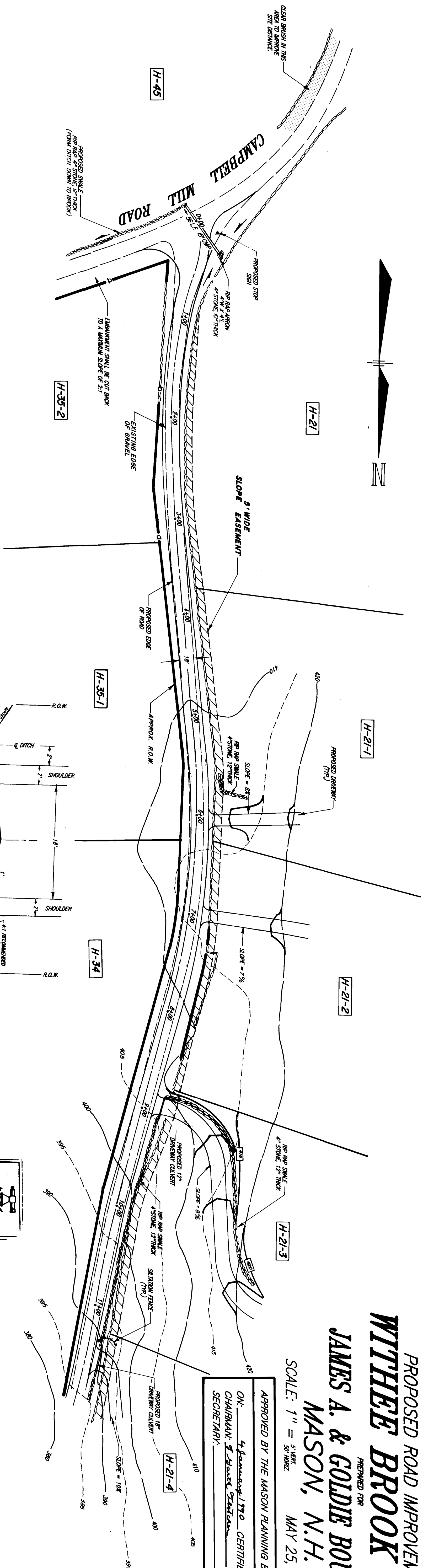

REV.	DATE	DESCRIPTION	C/O	DR	CK
	7/18/89	ADD 15" CMP AT INTERSECTION		R.S	R.H
	6/28/89	MINOR REVISIONS		R.S	R.H
	5/30/89	MINOR REVISIONS		R.S	R.H

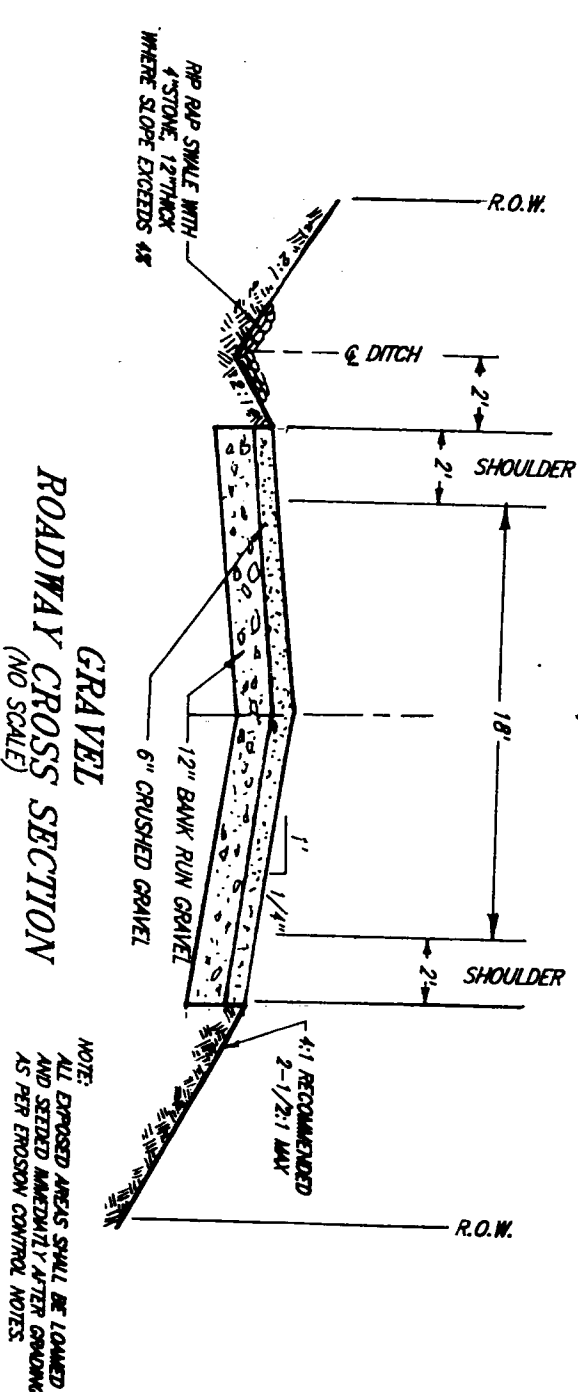
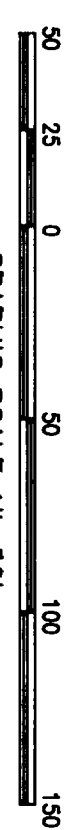

FOR DECATUR PURCHASE ONLY

*Barclay A. Haffner*



STATE OF MARYLAND  
DEPARTMENT OF TRANSPORTATION  
LICENSE NO. 670  
BARCLAY A. HAFFNER  
MOUNTAIN VIEW  
MARYLAND

**THOMAS F.  
MORAN INC.**

**surveyors  
civil engineers  
land planners**



AN HTA COMPANY

